

SPECTER® ROM BRACES

Model No:
37-0170
Specter ROM Standard

37-0174
Specter ROM
Cool/Lightweight

37-0176
Specter ROM Short

37-0172
Specter P-ROM
Paddle Standard

37-0182
Specter P-ROM
Paddle Long

Sizes: Universal

Universal Sizing

SPECTER® ROM BRACES

Standard Specter® ROM provides post-operative immobilization and range of motion needed after ACL, PCL, MCL and LCL surgeries.

- Strong Durable Hinge with Snap-Lock Design and Optional Patient Lock-Out
- 7.5 Degree Incremental Flexion/Extension Settings
- Integrated Strap/Strut Design
- Conformable Aluminum Struts for Varus/Valgus Position
- Breakdown Conversion to Shorter 4-Strap Design



**SPECTER®
ROM
Standard**
Model:
37-0170



**SPECTER® ROM
Cool/Lightweight**
Model: 37-0174

Cool and lightweight variation of the Standard Specter® ROM. Ideal for warmer climates and long term wear.

SPECTER® ROM Short
Model: 37-0176

Short version of Standard Specter® ROM. Ideal for post-operative patients during rehabilitation. Shorter length is more comfortable for ambulatory patients.



P-ROM
Models Have Sliding Support Paddles



Sliding Support Paddles are easy to adjust and set with lock-tight thumb screws. No tools or trimming required.



**SPECTER® P-ROM
PADDLE Standard**
Model: 37-0172



**SPECTER® P-ROM
PADDLE Long**
Model: 37-0182
For inseams of 33" or longer.

800-327-4110

See following pages for Application Instructions.

SPECTER® ROM BRACES

Model No:
37-0170
Specter ROM Standard

37-0174
Specter ROM
Cool/Lightweight

37-0176
Specter ROM Short

37-0172
Specter P-ROM
Paddle Standard

37-0182
Specter P-ROM
Paddle Long

Sizes: Universal

Not intended for unsupervised public use. Consult your physician if you experience pain, swelling or unusual reactions.



Specter® ROM & P-ROM Rehabilitation Braces

Suggested Application Guidelines

Includes application instructions for Specter® ROM Standard, Short & Cool, and Specter® P-ROM Standard & Long.

INDICATIONS:

Specter® Rehab Braces are indicated for post-operative immobilization and range of motion needed after surgeries of the anterior cruciate ligament, posterior cruciate ligament, medial collateral ligament, lateral collateral ligament, or for any knee condition requiring limited range of motion.

STEP ONE: SETTING THE HINGE For all ROM and P-ROM Braces.

Use these instructions for all above models.

1. Remove the optional lock nut with the provided hex wrench.
2. Slide back the spring lock stop and rotate the hinge cover to expose the flexion stop pin. Place pin in desired setting - pin holes are in 7.5 degree increments and the numbers on the hinge correspond to the outside row.

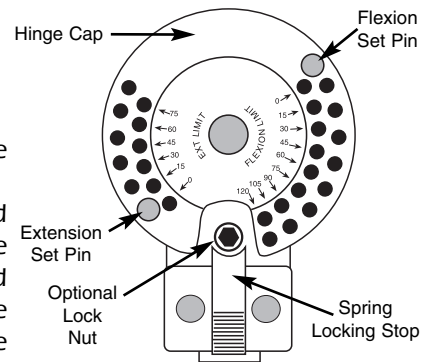

3. Rotate the hinge cover to expose the extension stop and set pin. Reposition the hinge cover and release the spring lock stop into the notch.
3. As an option, when compliance is an issue, the optional locking nut can be replaced and tightened for patient lock-out.
4. Set both the medial and lateral hinges to the same settings.

GENERAL INSTRUCTIONS:

The aluminum side struts on Specter® ROM and P-ROM Braces can be bent to accommodate varus or valgus contouring. Bend each bar an equal amount above and below the hinge. Grasp the bar below the score line while bending to prevent breakage at the score line.

FOAM WRAPS:

All foam wraps are universally sized and are easily trimmed with scissors. Hand wash foam wraps in cold water with mild soap. Squeeze out excess water and air dry only.

Federal Law restricts this device to sale by or on the order of a licensed health care professional.

800-327-4110

FLA ORTHOPEDICS®

Website: www.flaorthopedics.com

©2002 FLA ORTHOPEDICS, INC.

SPECTER® ROM BRACES

Model No:

37-0170

Specter ROM Standard

37-0174

Specter ROM

Cool/Lightweight

37-0176

Specter ROM Short

37-0172

Specter P-ROM

Paddle Standard

37-0182

Specter P-ROM

Paddle Long

Sizes: Universal



Instructions for SPECTER® ROM

STANDARD & SHORT

STEP ONE:

See Front for Step One - Setting the Hinge.

STEP TWO: APPLYING THE BRACE

1. Remove the foam wraps from the brace. Apply the universal thigh and calf wraps until snug. Position so hook and loop closure is on the anterior surface and the popliteal cut out is behind the knee. Overlap in excess of two inches should be trimmed.
2. Press the medial and lateral hinge struts to the wraps so that they are along the midline of the leg and the respective hinge center points of rotation are parallel. This position should correspond with the normal center on the knee.
3. Secure the brace to the leg by looping the straps through the D-rings; fasten the knee straps first and then alternate securing the remaining straps between the thigh and calf. When straps are secured check for proper alignment and readjust if necessary.

To remove brace, unfasten straps and open the foam wraps; remove and reapply as a single unit.

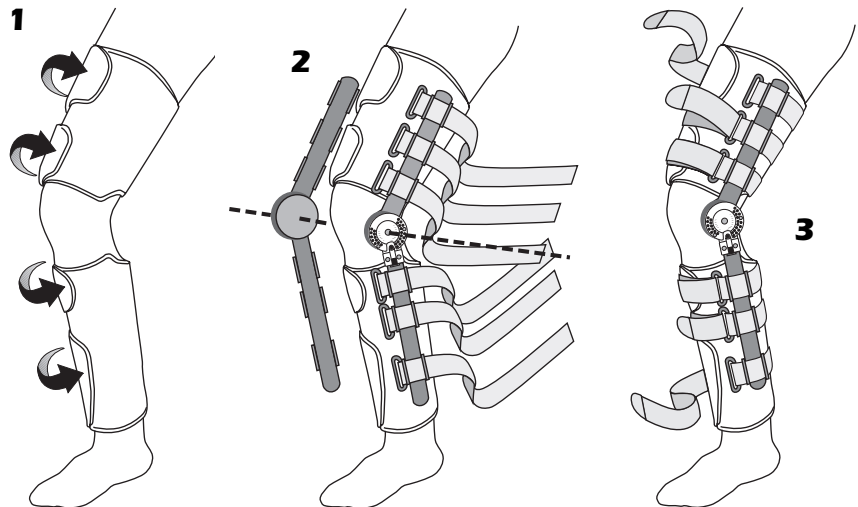

Always consult your medical professional before making changes to the brace.

800-327-4110

FLA ORTHOPEDICS®

Website: www.flaorthopedics.com

©2002 FLA ORTHOPEDICS, INC.

SPECTER® ROM BRACES

Model No:
37-0170
Specter ROM Standard

37-0174
Specter ROM
Cool/Lightweight

37-0176
Specter ROM Short

37-0172
Specter P-ROM
Paddle Standard

37-0182
Specter P-ROM
Paddle Long

Sizes: Universal

Instructions for SPECTER® ROM COOL



STEP ONE: See Front for Step One - Setting the Hinge.

STEP TWO: APPLYING THE BRACE

1. Remove the foam liners from the brace. Attach the lateral hinge strut to the foam liners leaving approximately 4 inches of liner to the front.
2. Position the lateral hinge strut parallel to the leg with the hinge centered with the normal center of knee rotation. Secure the foam liners until snug and engage the hook closure on the anterior surface.
3. Press the medial hinge strut to the liners so that the respective hinge center points of rotation are parallel.
4. Secure the brace to the leg by looping the straps through the D-rings; fasten the knee straps first and then alternate securing the remaining straps between the thigh and calf. When straps are secured check for proper alignment and readjust if necessary.

To remove brace, unfasten straps and open foam liners; remove and reapply as a single unit.

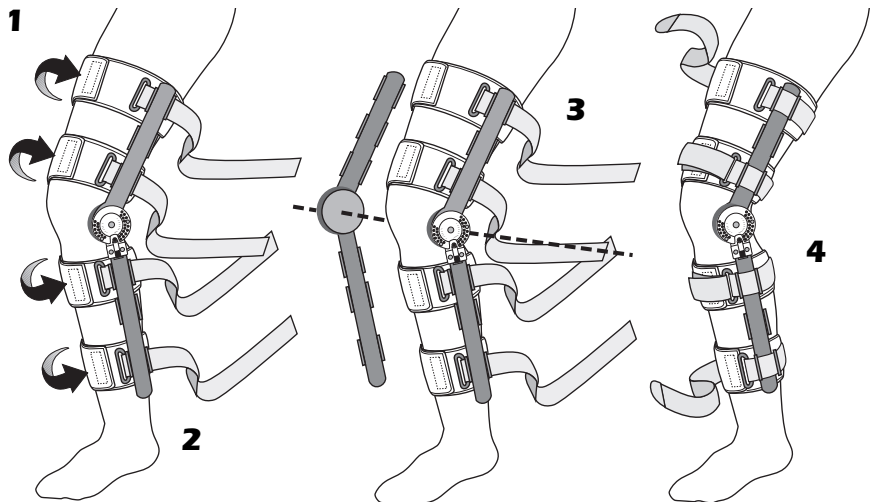

Always consult your medical professional before making changes to the brace.

NOTE: THIS DEVICE IS ONLY ONE ELEMENT IN THE OVERALL TREATMENT PROGRAM ADMINISTERED BY A MEDICAL PROFESSIONAL. THERE IS NO GUARANTEE THAT INJURY WILL BE PREVENTED THROUGH THE USE OF THIS PRODUCT.

CLINITEX® MEDICAL CORPORATION ■ HUNTERVILLE, NC

A SUBSIDIARY OF FLA ORTHOPEDICS, INC.

Federal Law restricts this device to sale by or on the order of a licensed health care professional.

©1998 FLA ORTHOPEDICS, INC.

800-327-4110

FLA ORTHOPEDICS®

Website: www.flaoorthopedics.com

©2002 FLA ORTHOPEDICS, INC.

SPECTER® ROM BRACES

Model No:

37-0170

Specter ROM Standard

37-0174

Specter ROM

Cool/Lightweight

37-0176

Specter ROM Short

37-0172

Specter P-ROM

Paddle Standard

37-0182

Specter P-ROM

Paddle Long

Sizes: Universal



Instructions for SPECTER® P-ROM

STANDARD & LONG

STEP ONE: See Front for Step One - Setting the Hinge.

STEP TWO: APPLYING THE BRACE

1. Remove the foam wraps from the brace. Apply the universal thigh and calf wraps until snug. Position so hook and loop closure is on the anterior surface and the popliteal cut out is behind the knee. Overlap in excess of two inches should be trimmed.
2. Adjust the paddle position. Loosen the thumb nuts and slide the paddles to achieve the desired length. Re-tighten thumb nuts. Paddles should fit approximately two (2) inches above the malleoli and adequately clear the groin area.
3. Press the medial and lateral hinge struts and paddles to the wraps so that they are along the midline of the leg and the respective hinge center points of rotation are parallel. This position should correspond with the normal center on the knee.
4. Secure the brace to the leg by looping the straps through the D-rings; fasten the knee straps first and then alternate securing the remaining straps between the thigh and calf. In the long version with the angulated tension links, first align the back straps and then the front ensuring the hinges remain centered and aligned. Trim excess velcro strap.

To remove brace, unfasten straps and open the foam wraps; remove and reapply as a single unit.

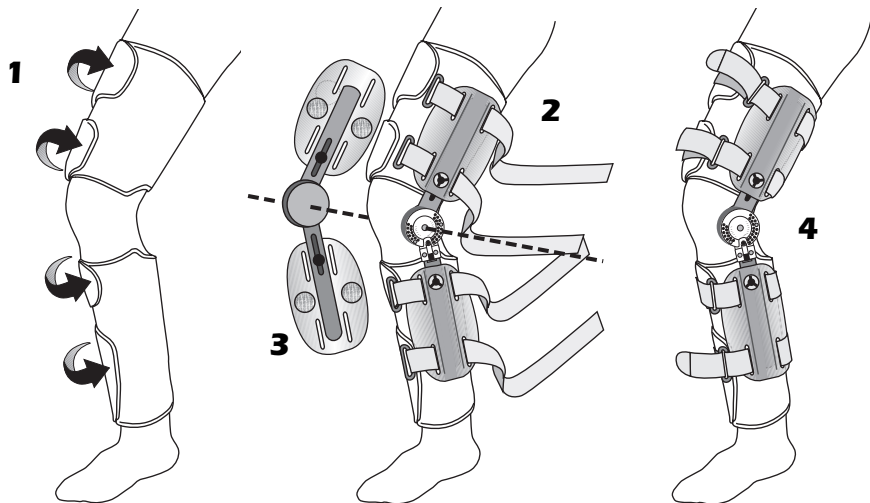

Always consult your medical professional before making changes to the brace.

©1998 FLA ORTHOPEDICS, INC.

800-327-4110

FLA ORTHOPEDICS®

Website: www.flaorthopedics.com

©2002 FLA ORTHOPEDICS, INC.